

REV	DESCRIPTION	DRW.	DATE
00	初版发行	L.K	2025.01.21

02P~06P: 两侧带卡槽
 07P以上(包含07P): 两侧不带卡槽/
 02P~06P: There are card slots on both sides
 07P or above (including 07P): There are no card slots on both sides

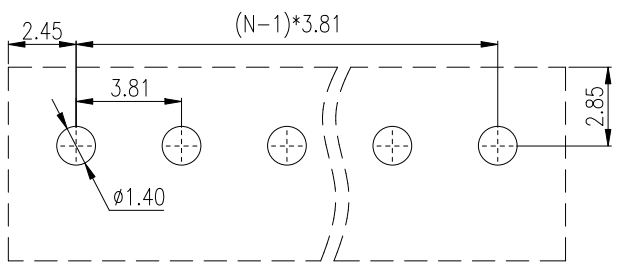
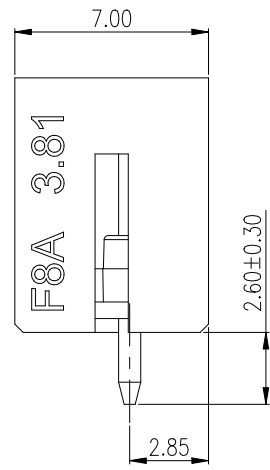
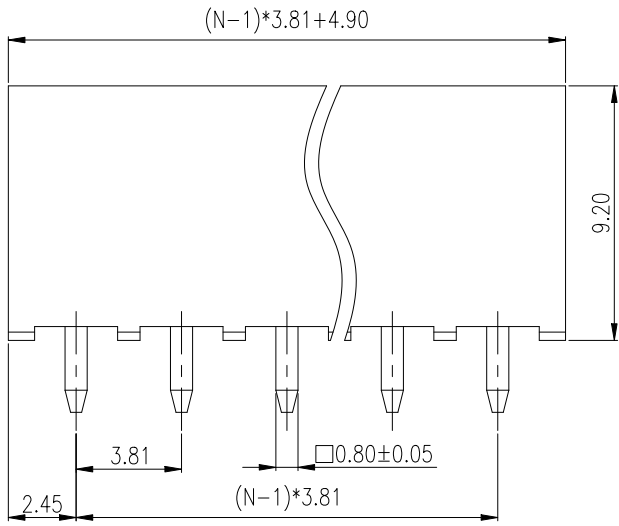
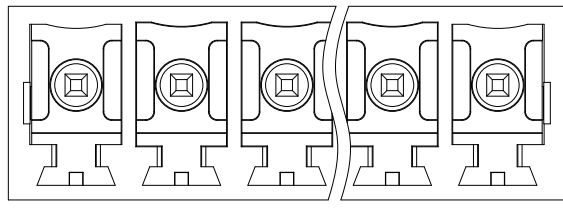
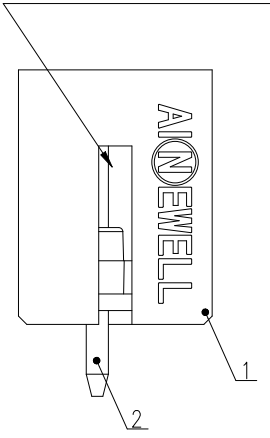

PCB LAYOUT

Notes/备注:

1. Electrical properties/电气特性
 UL Standard/UL标准

Use Group/应用组别	B	C	D
Rated Voltage/额定电压 (V)	300	/	300
Rated Current/额定电流 (A)	8	/	8
Withstanding voltage/工频耐压	AC 1600V/1Min		

IEC Standard/IEC标准

Rated Voltage/额定电压 (V): 320
 Rated Current/额定电流 (A): 10

Overvoltage Category/过电压类别 /Pollution Degree/污染等级	II/2	III/2	III/3
Voltage/电压 (V)	320	160	160
Rated Impulse Voltage/冲击耐压(KV)	2.5	2.5	2.5

2. Environmental safety/环境安全

Operating temperature/工作温度范围(℃): -40~+105
 RoHS compliant/符合RoHS环保要求

2	PIN HEADER 焊针	Copper Alloy	Sn Plated
1	HOUSING 主体	LCP	UL94 V-0
ITEM	NAME OF PART	MATERIAL	NOTES

Part No./料号说明:

F8A-1-3.81-XXP-A-THR-L26

Poles/P数
 02: 2Poles
 03: 3Poles
 ...
 24: 24Poles
 A: Black/黑色

Nominal dimension		Tolerances (mm)					
0	over 18	over 30	over 50	over 80	over 120	over 180	over 250
to 18	to 30	to 50	to 80	to 120	to 180	to 250	to 320
	±0.25	±0.3	±0.35	±0.5	±0.7	±0.9	±1.2

APP. M.X.B	DATE: 2025.01.21	PART NO.: F8A-1-3.81-XXP-A-THR-L26	
CHK. C.W	DATE: 2025.01.21	DARWING TYPE: Customer Drawing	
DRW. L.K	DATE: 2025.01.21	UNITS: mm	SCALE: 5:1 SHEET/OF: 1/1
PROJECTION			
		昆山艾尼维尔电子有限公司 KUN SHAN AINEWELL ELECTRONICS CO.,LTD	